

The Endless City

SURE | London | 2014



Solution to urban sprawl and overpopulation: .The irregular street (ramps) directions create a variety of space and atmosphere. And the bridges connect the ramps resulting in vertical and horizontal movement to increase interaction, communication, and exchanges. These links allow an interconnection of spatial different spaces, from public space, entertainment spaces, storefronts, to parks, and auditorium.



UPRISING STREETS

Ramp gradually rises with storefronts lining one side. (Bustler)

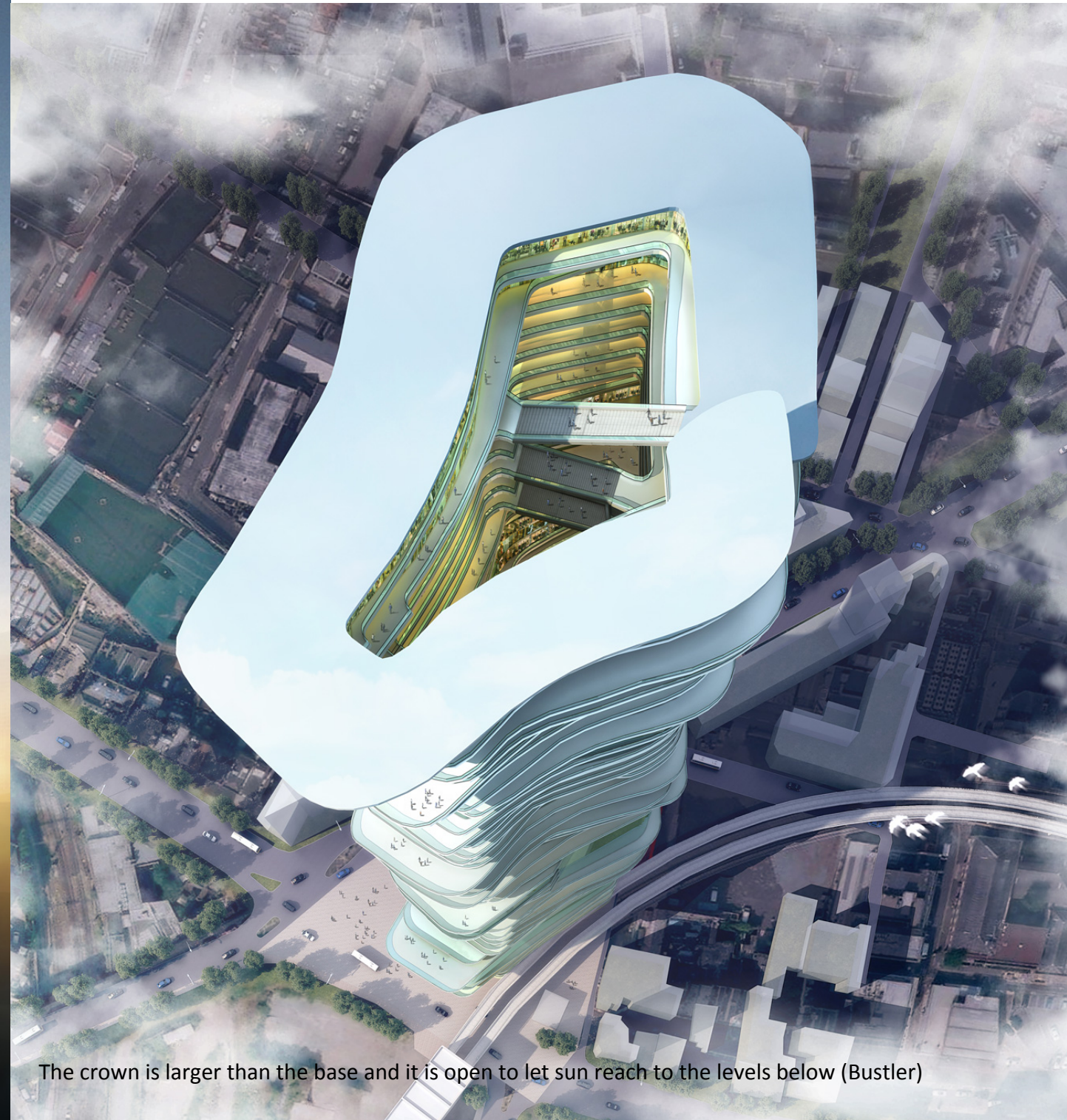

The crown is larger than the base and it is open to let sun reach to the levels below (Bustler)

Vertical connection: The typical skyscraper has floor stacked on top of each other but Endless City has two continuously ramp that gradually rises from the ground to the sky. Additionally, bridges connect the ramps internally.



Bridge connecting the interiors (Archdaily)

Sustainable design: The skyscraper is shaped by local constraints and orientations. The base of the building is narrow to meet zoning codes but gets spread at the crown to let as much natural light. The building shape is optimized for maximum passive energy; reduce artificial lighting, ventilation, and cooling.

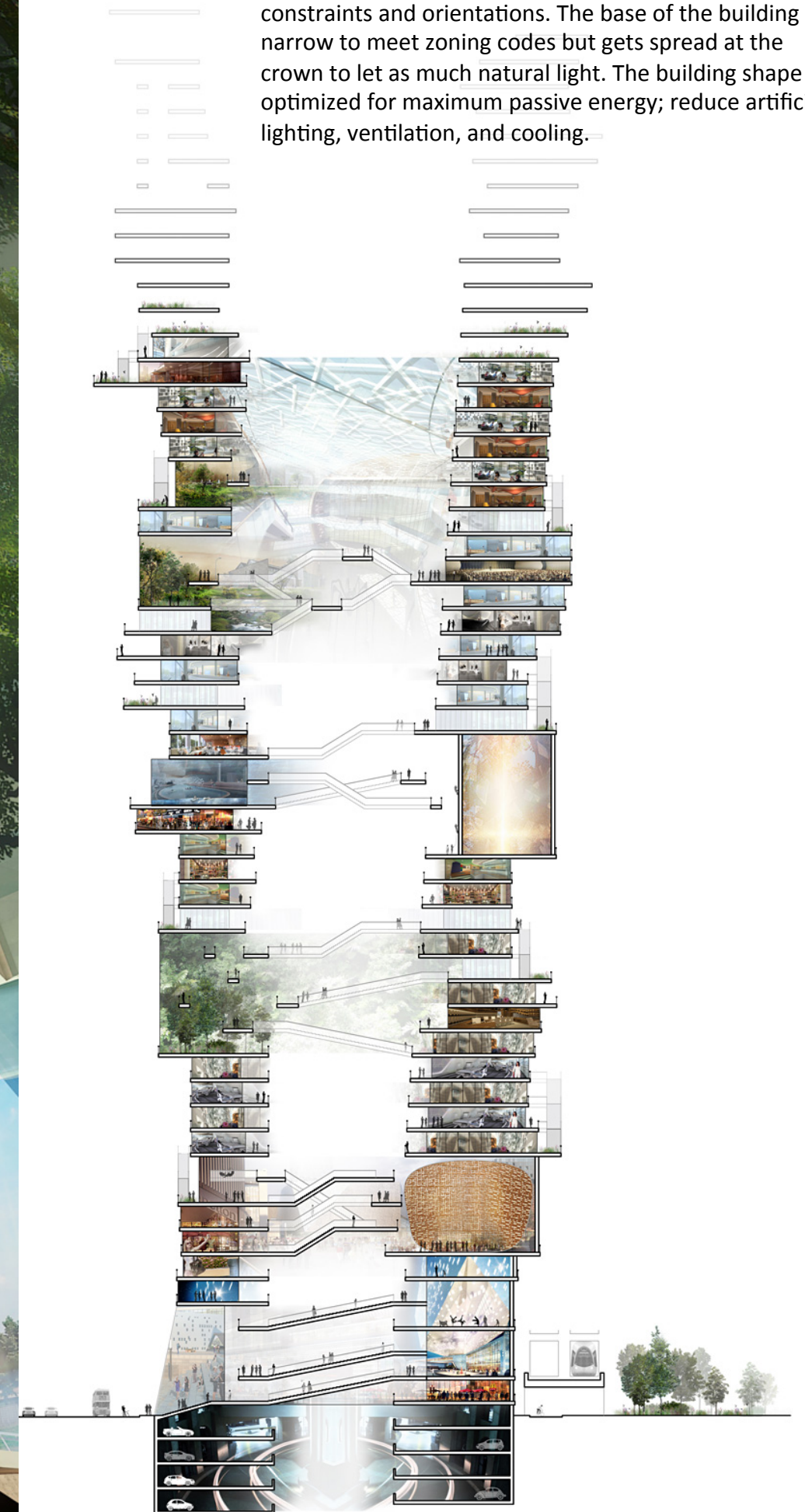

Section shows the building opening up as it reach for the sky. (Archdaily)

Work Cited

Hobson, Bed. "MAD Wants to "invent a New Typology" for High-rise Architecture, Says Ma Yansong." Dezeen Magazine. N.p., 6 Aug. 2014. Web. 4 Oct. 2015. <<http://www.dezeen.com/2014/08/06/movie-interview-ma-yansong-mad-shan-shui-city-invent-new-typology-high-rise-architecture/>>.

The video gives a lots information about the purpose, origination and diagrams of shan-shui city projects.

"Ma Yansong / MAD Architects: Shan Shui City at Designboom Conversation." Designboom Architecture Design Magazine Ma Yansong MAD Architects Shan Shui City at Designboom Conversation Comments. N.p., 11 Dec. 2012. Web. 04 Oct. 2015. <<http://www.designboom.com/architecture/mad-architects-shan-shui-city-guiyang-china/>>.

Websites contains render images of the projects as well as the related exhibition.

"SURE Architecture's Winning "Endless City" Skyscraper Proposal for the Streets of London." <i>Bustler</i>. N.p., 30 July 2014. Web. 04 Oct. 2015. <http://www.bustler.net/index.php/article/sure_architectures_winning_endless_city_skyscraper_proposal_for_the_streets/>.

Buster has goes into the detail of why the designers made certain choices.

"SURE Wins Competition with "Endless City" Skyscraper." ArchDaily. N.p., 24 July 2014. Web. 04 Oct. 2015. <<http://www.archdaily.com/530801/sure-wins-competition-with-endless-city-skyscraper>>.

Archdaily is a reputable site for architectural projects including conceptual and built structures.

Stevens, Phillip. "MAD presents cloud corridor residences at the A+D museum's inaugural exhibition." 28 August 2015. <http://www.designboom.com/architecture/mad-architects-ma-yansong-cloud-corridor-shelter-rethinking-how-we-live-in-los-angeles-08-28-2015/>

Steven's discusses the philosophy of Ma Yansong's as it pertains to the exhibition of "Cloud Corridor."

Wang, Lucy. "MAD Architects unveil futuristic Cloud Corridor skyscrapers for Los Angeles." September 2015. <http://inhabitat.com/mad-architects-unveil-futuristic-cloud-corridor-skyscrapers-for-los-angeles/>

Wang discusses in her article the vision for "Cloud Corridor" through reinterpretation of proposal.

<http://www.i-mad.com/work/cloud-corridor/?cid=4>

The official site of MAD architects contains images of the project.