

ROAD
CLOSED

3000SF AREA OF SHUTDOWN TO POTHOLE FORCE MAIN SEWER AND STORM LINES

ROAD
CLOSED



No
Right
Turn



At Parking Garage Entrance



No
Through
Traffic



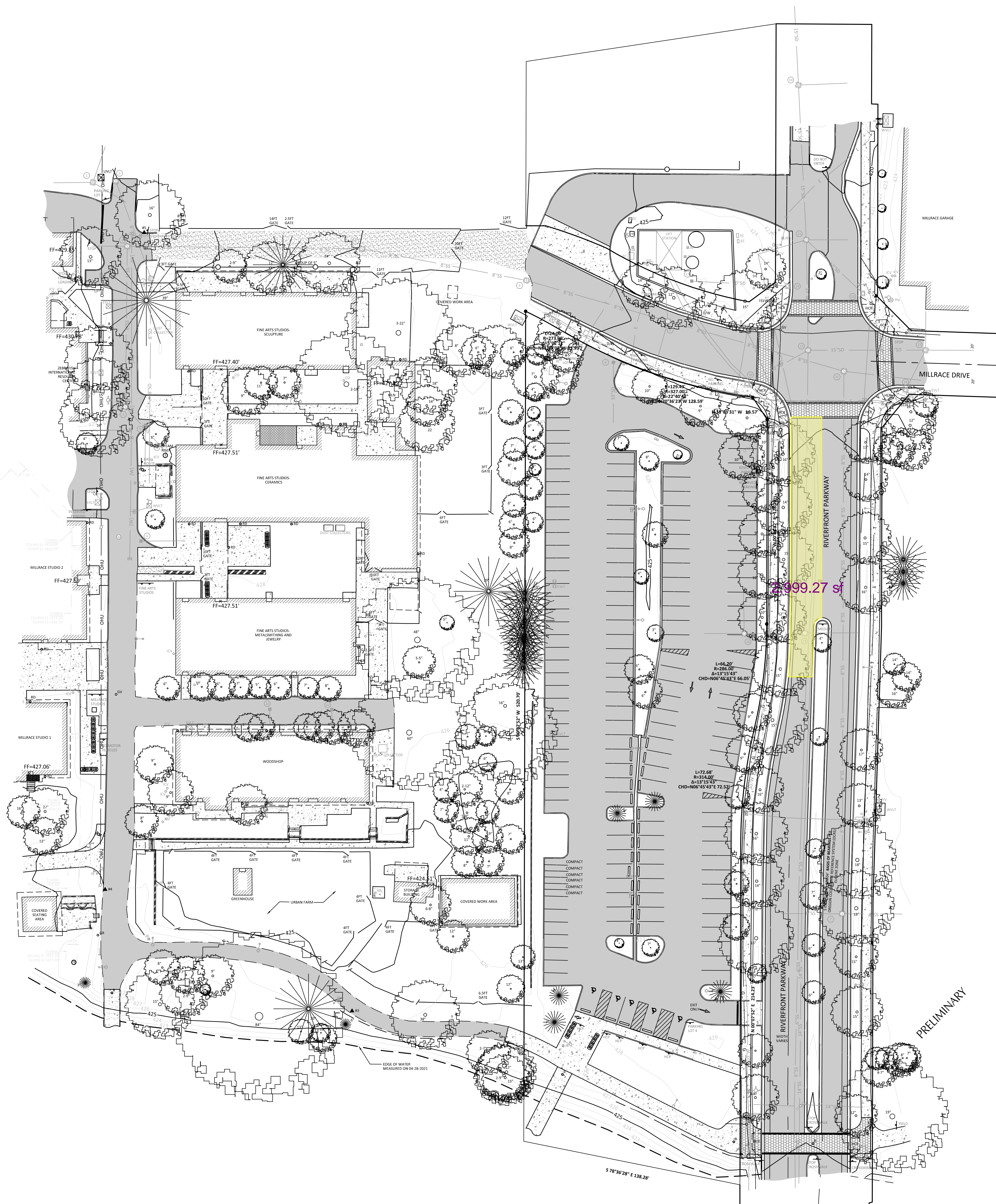

LEGEND:

	BUILDING OUTLINE WITH DOOR
	CONCRETE SURFACE
	BRICK SURFACE
	ASPHALT SURFACE
	WALL
	BUILDING OVERHANG
	CURB LINE
	EDGE OF ASPHALT
	RIGHT-OF-WAY LINE
	EASEMENT LINE
	LOT LINE
	PROPERTY LINE
	ELECTRICAL LINE
	TELECOMMUNICATIONS LINE
	STORM LINE
	SANITARY SEWER LINE
	WATER LINE
	GAS LINE
	OVERHEAD UTILITY LINES
	UNDERGROUND LINE PER AS-BUILT
	SIGN
	DOUBLE POST SIGN
	BOLLARD
	DRIVEWAY ENTRY
	HANDICAP RAMP
	BLDG RACK
	ROOF DRAIN
	ELECTRICAL MANHOLE
	ELECTRICAL JUNCTION BOX
	ELECTRICAL METER
	ELECTRICAL RISER
	ELECTRICAL CABINET
	ELECTRICAL VAULT
	TRANSFORMER
	GUY ANCHOR
	GUY POLE
	POWER POLE
	OVERHEAD LIGHT
	POWER POLE/OVERHEAD LIGHT
	GAS METER
	GAS RISER
	GAS VALVE
	SANITARY MANHOLE WITH STRUCTURE
	STORM MANHOLE WITH STRUCTURE
	CATCH BASIN
	CURB INLET
	AREA DRAIN
	SANITARY/STORM CLEAN OUT
	SANITARY/STORM STRUCTURE #
	TELECOMMUNICATIONS MANHOLE
	TELECOMMUNICATIONS VAULT
	TELECOMMUNICATIONS RISER
	FIBER OPTIC VAULT
	WATER VALVE
	FIRE HYDRANT
	WATER METER
	POST INDICATOR VALVE
	FIRE DEPARTMENT CONNECT
	WATER MANHOLE
	WATER VAULT
	HOSE BIB
	IRRIGATION CONTROL VALVE
	STEAM MANHOLE
	TUNNEL ENTRANCE MANHOLE
	UNKNOWN VAULT
	EMERGENCY CALL
	DECIDUOUS TREE
	PERIMETER REPRESENTS DRIPLINE
	CONIFEROUS TREE
	PERIMETER REPRESENTS DRIPLINE
	FOUND MONUMENT
	PROJECT CONTROL POINT

NOTES:

- 1.) VERTICAL DATUM: NAVD 88 (GEOID 12A)
ELEVATION WAS ESTABLISHED THROUGH A GPS OBSERVATION ON CONTROL POINT NO. 1 USING THE OREGON REAL-TIME GPS NETWORK (ORGN).
- 2.) BASIS OF BEARINGS FOR THIS SURVEY IS THE OREGON COORDINATE REFERENCE SYSTEM (OCRS), EUGENE ZONE. THE RESULTANT BEARING BETWEEN CONTROL POINTS 1 AND 2 IS SOUTH 09°57'28" WEST.
- 3.) BOUNDARY AND EASEMENTS SHOWN HEREON ARE BASED ON TITLE REPORT NO. 0265272 BY CASCADE TITLE COMPANY, EFFECTIVE DATE JANUARY 28, 2020. THE TITLE REPORT REFERENCED ABOVE ONLY APPLIES TO A PORTION OF THE SITE SHOWN HEREON. OTHER EASEMENTS MAY EXIST.
- 4.) UTILITY LOCATIONS SHOWN ARE PER FIELD LOCATED UTILITY PAINT MARKS & REFERENCE MAPS MADE AVAILABLE BY THE VARIOUS UTILITY PROVIDERS. UNLESS INDICATED, DEPTHS OF UTILITY LINES ARE NOT AVAILABLE. ALL UTILITY LOCATIONS SHOULD BE FIELD VERIFIED (POTHOLED) PRIOR TO CONSTRUCTION.
- 5.) HORIZONTAL AND VERTICAL TUNNEL POSITION MEASURED TO INTERIOR WALL FACE.

STORM TABLE:

1	STORM MANHOLE RIM = 429.80 IE 4" IN (SE) = 426.21' IE 4" IN (NW) = 425.12' IE 4" OUT (W) = 424.88'
2	STORM MANHOLE RIM = 429.88 IE 8" IN (SE) = 427.14' IE 8" OUT (S) = 426.47'
3	STORM MANHOLE RIM = 428.22 IE 8" IN (NW) = 426.54' IE 8" OUT (S) = 425.51'
4	CATCH BASIN RIM = 427.17 IE 8" IN (N) = 425.51' IE 8" OUT (S) = 425.51'
5	CATCH BASIN RIM = 426.88 IE 6" OUT (S) = 425.72' IE 6" OUT (N) = 426.41'
6	CATCH BASIN RIM = 426.84 IE 6" IN (N) = 425.79' IE 4" OUT (N) = 426.41'
7	AREA DRAIN RIM = 427.85 IE 4" OUT (S) = 423.97'
8	CATCH BASIN RIM = 425.30 IE 10" OUT (S) = 423.97'
9	STORM MANHOLE RIM = 416.07 IE 8" IN (NW) = 409.12' IE 12" IN (N) = 409.08' IE 8" IN (W) = 409.10' IE 15" OUT (S) = 408.98'
10	STORM MANHOLE RIM = 417.63 IE 15" IN (N) = 408.41' IE 15" OUT (S) = 408.39'
11	STORM MANHOLE RIM = 421.89 IE 15" IN (S) = 411.84' IE 12" IN (SE) = 411.41' IE 12" IN (E) = 411.89' IE 15" IN (N) = 407.79' IE 24" OUT (SW) = 407.78'

SANITARY TABLE:

1	SANITARY MANHOLE RIM = 427.40 IE 6" IN (SE) = 424.58' IE 6" OUT (N) = 424.30' IE 15" IN (E) = 414.21' IE 15" OUT (N) = 414.06'
2	SANITARY MANHOLE RIM = 428.93 IE 8" IN (W) = 420.33' IE 6" IN (S) = 421.18' IE 8" OUT (E) = 419.20'
3	SANITARY MANHOLE RIM = 429.95 IE 8" IN (W) = 416.08' IE 8" IN (NW) = 416.04'
4	SANITARY MANHOLE RIM = 426.34 IE 8" IN (NW) = 415.62' IE 8" OUT (SE) = 415.52'
5	SANITARY MANHOLE RIM = 424.41 IE 8" IN (NW) = 414.82' IE 6" IN (SW) = 415.03' IE 6" IN (SE) = 414.85' IE 8" OUT (NE) = 414.78'
6	SANITARY MANHOLE RIM = 423.65 IE 8" IN (S) = 416.45' IE 8" IN (E) = 416.55' IE 8" OUT (NW) = 416.39'
7	SANITARY MANHOLE RIM = 426.93 IE 8" IN (W) = 419.92' IE 8" IN (E) = 419.88' IE 8" OUT (N) = 419.59'
12	STORM MANHOLE RIM = 423.23 IE 10" IN (SW) = 418.21' IE 10" IN (S) = 418.29' IE 15" IN (E) = 414.21' IE 15" OUT (N) = 414.06'
13	CATCH BASIN RIM = 423.71 IE 10" OUT (E) = 419.41'
14	CURB INLET RIM = 422.40 IE 10" IN (W) = 418.63' IE 10" OUT (NW) = 418.31'
15	CURB INLET RIM = 422.34 IE 12" OUT (NW) = 417.39'
16	CURB INLET RIM = 424.08 IE 10" OUT (NE) = 421.13'
17	STORM MANHOLE RIM = 423.70 IE 10" IN (S) = 419.34' IE 15" IN (E) = 414.78' IE 10" IN (N) = 419.64' IE 15" OUT (W) = 414.71'
18	CURB INLET RIM = 423.79 IE 10" OUT (N) = 418.83'
19	STORM MANHOLE RIM = 425.28 IE 10" IN (W) = 419.90' IE 10" IN (E) = 419.96' IE 12" OUT (N) = 415.68'
20	STORM MANHOLE RIM = 426.86 IE 8" IN (W) = 421.14' IE 8" IN (W) = 421.10' IE 10" OUT (E) = 419.96'
21	CATCH BASIN RIM = 426.40 IE 6" OUT (S) = 425.51'
22	CATCH BASIN RIM = 426.83 IE 6" OUT (S) = 425.51'

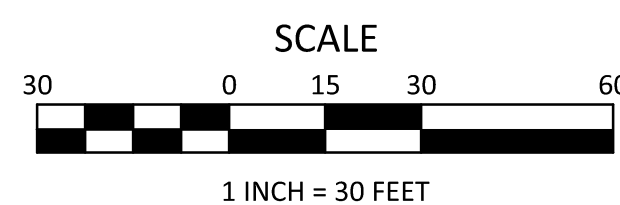
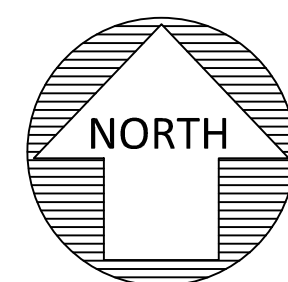

PROJECT CONTROL:

STATION	DESCRIPTION	NORTHING	EASTING	ELEVATION
1	1-1/8" BRASS CAP "KPFF CONTROL"	108955.02	189557.12	422.54'
2	1-1/8" BRASS CAP "KPFF CONTROL"	108336.21	189517.92	432.61'
3	MAG NAIL W/ WASHER "KPFF CONTROL"	108506.61	189228.52	425.59'
4	MAG NAIL W/ WASHER "KPFF CONTROL"	108582.80	189073.67	427.08'
5	1-1/8" BRASS CAP "KPFF CONTROL"	108994.92	189098.17	429.68'