

Living our Values

UO ARCHITECTURE 2018 FACULTY RETREAT



UNIVERSITY OF
OREGON

School of Architecture
& Environment

Department of Architecture

SCHEDULE

8:30 Coffee and socializing

9:00 Living our values (Nancy): brainstorming >> planning >> action

Strategic planning: getting on the same page (John)

Breakout w/ report back: research themes & identify action items

10:30: What makes you committed to this place? How could we support you better? (Mark G)

Breakout w/report back

12:00 Lunch: cluster around curricular areas

1:00 Stephen Duff on technology integration

Pecha Kucha sharing of summer updates

2:30 Vote : Ad Hoc Committee & NTTF for Personnel Committee

3:30 flex time to follow up on the above



Unbuilding Walls: German Pavilion@Venice Biennale



Unbuilding Walls: German Pavilion@Venice Biennale



Unbuilding Walls: German Pavilion@Venice Biennale



Israeli Pavilion @ Venice Biennale

Abraham, Abraham, Sarah, Sarah video installation by Nira Pereg

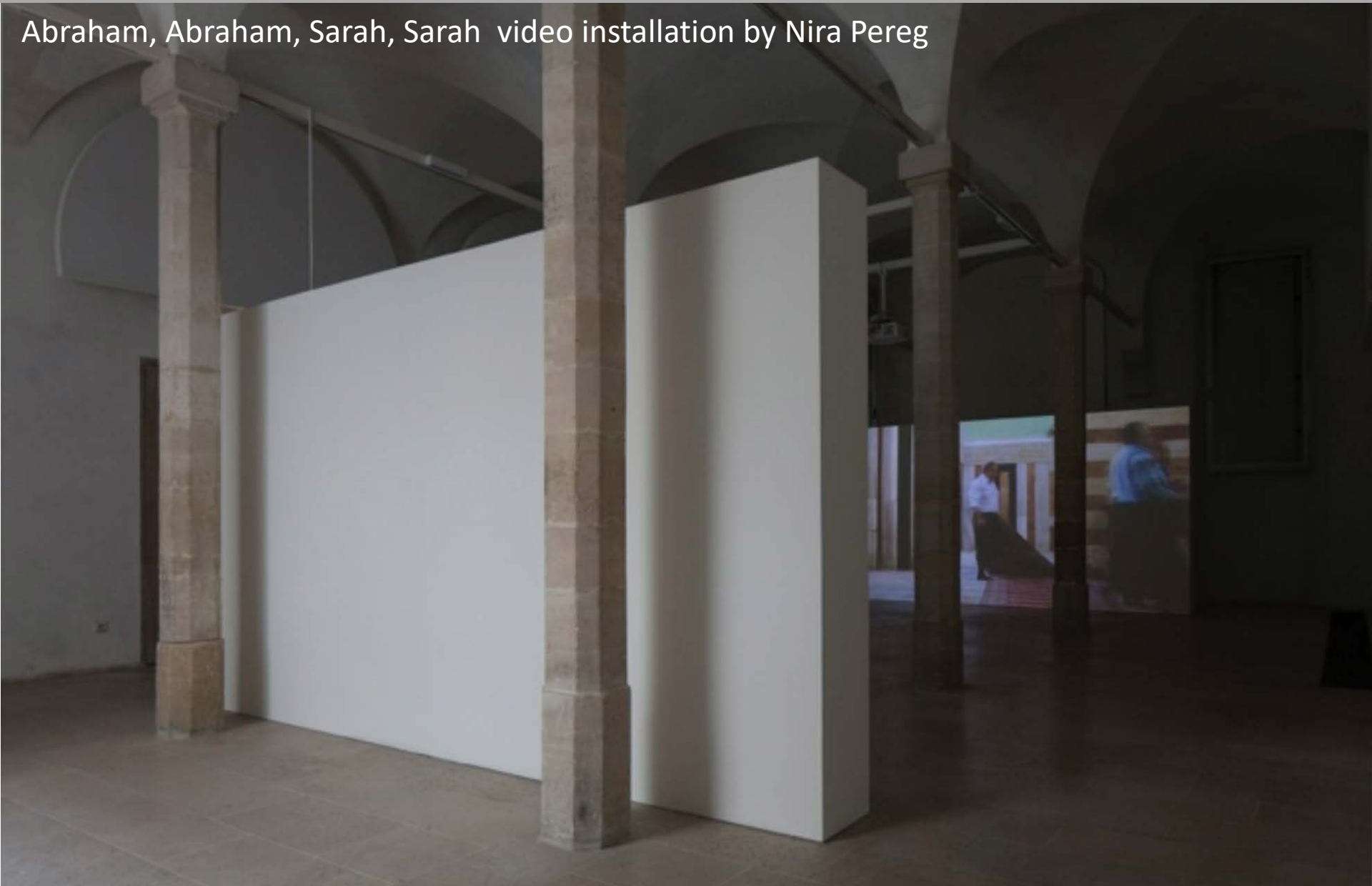

Israeli Pavilion@Venice Biennale



UNIVERSITY OF
OREGON

Abraham, Abraham, Sarah, Sarah
& Environment

video installation by Nira Pereg of Architecture

The Golden Circle

WHAT

Every organization on the planet knows WHAT they do. These are products they sell or the services

HOW

Some organizations know HOW they do it. These are the things that make them special or set them apart from their competition.

WHY

Very few organizations know WHY they do what they do. WHY is not about making money. That's a result. WHY is a purpose, cause or belief. It's the very reason your organization exists.

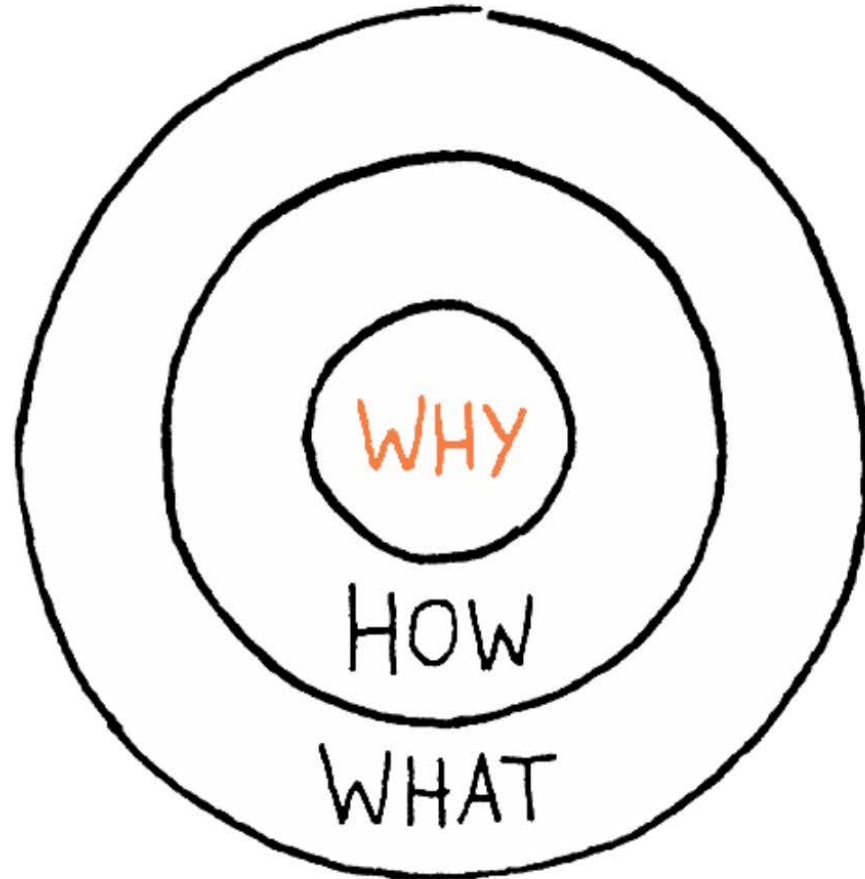

2018-19 Framework – a work in progress

	FALL 2018	WINTER 2019	SPRING 2019
	GATHER IDEAS	REFINE MESSAGE	SPREAD THE WORD
IDENTITY	Define key areas, needs & opportunities	Branding graphics & text draft	Articulate plan w Action items
	One-page focus summaries	Define Strategic Planning principles	
ORGANIZATION	Discuss w students & alumni		
	Create topical workgroups to support goals		
	Create collection system for Accreditation & UG Assessment		
RESEARCH	Focus group meetups? Trainings	Fund low-threshold experiments	Fund Research Collaborations
	Grantwriting workshop		
TEACHING	Brainstorm workshops	Specialization course sequences	PhD symposium
	Study new studio schedule options		
OUTREACH	Build external board of allies	Plan lectures, workshops & exhibits around themes	Recruitment
	Plan alumni + student events	Seed Social Media	One big event in late April
		Clarify fundraising needs	Plan Fall showcase





ROME Watercolors – Via Giulia & Views from the Palazzo Pio

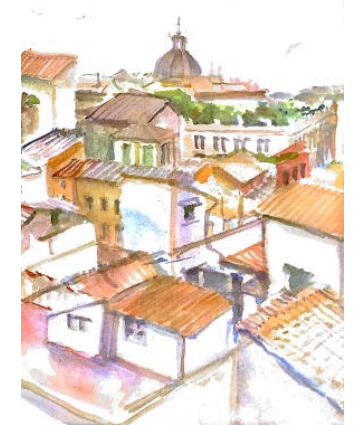

Howard Davis

Research in London toward my new book
Working Cities: Architecture, Place and Production



Pottery kilns near Kings Cross, 1860s *Mus of London*

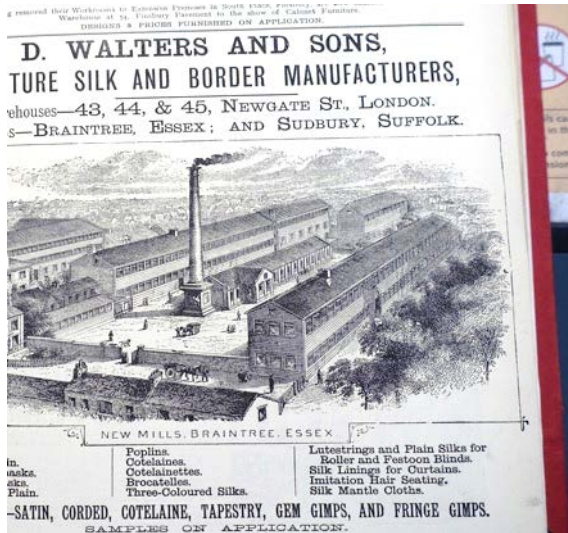

Ad in furniture journal, 1900 *British Library*

COM

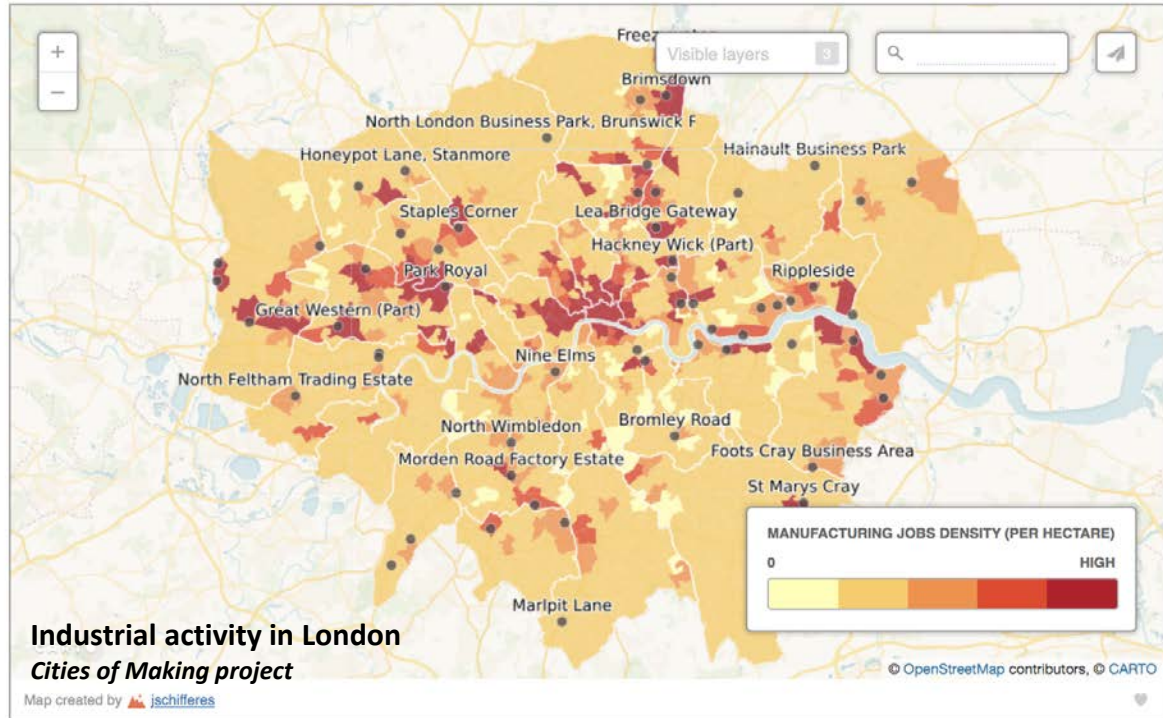

You can search our map using your London postcode and explore how much manufacturing takes place in your local area. Toggle the visible layers buttons to switch from employment to business size metrics.



We partnered with the University of Oregon to study the move from our former Valley Forge location to our Malvern headquarters. The study details how a systems-based approach to design can positively impact thermal, visual and acoustical comfort, and indoor air quality to achieve overall **multi-comfort**, productivity, and well-being.

HQ OCCUPANTS REPORTED



Ihab Elzeyadi concluded a 36-month Indoor Environmental Quality (IEQ) field study and design assistance services for Saint-Gobain North America Headquarters. This 277,000 S.F. double LEED platinum building housing 800 employees represents the largest comprehensive pre-post occupancy evaluation of its kind to quantify the impact of green buildings on occupant's multi-comfort, productivity, health, and well-being. The study is published and reported on in 14 major news outlets and 9 papers in journals and conference proceedings.

Michael Fifield

Pro-bono house compleed in Emerald Village, Eugene



6. 6. 5. 4. 3. 2. 1.



Peter Keyes

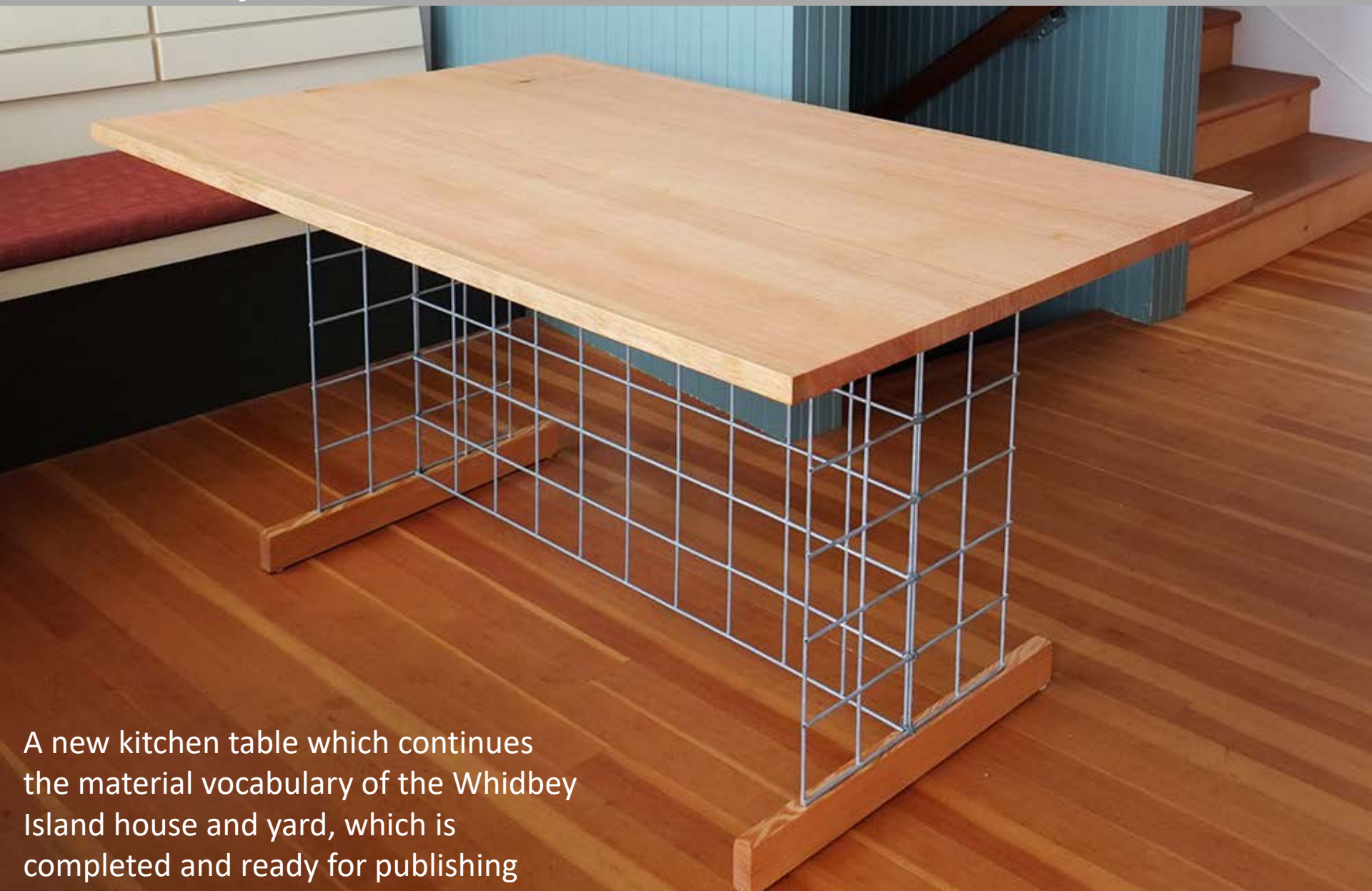

A new kitchen table which continues the material vocabulary of the Whidbey Island house and yard, which is completed and ready for publishing

Brook Muller

Architecture as Ecological Infrastructure

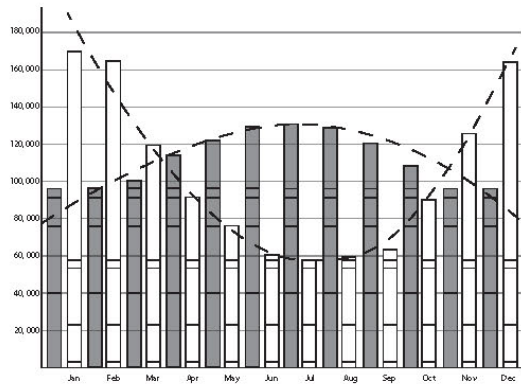
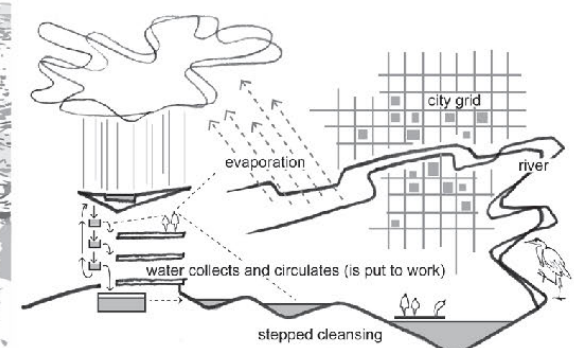
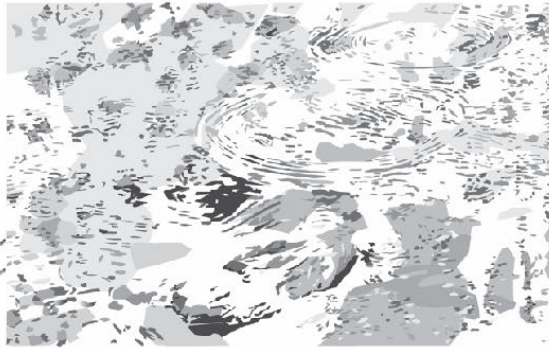
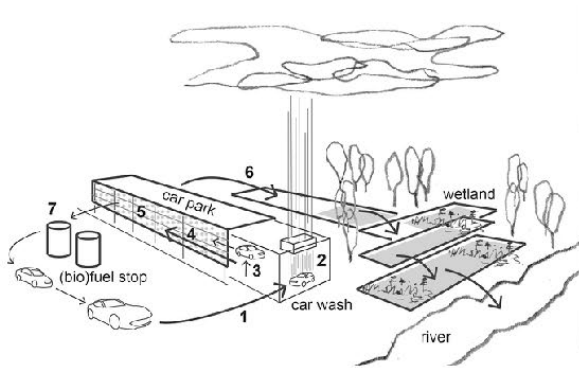

ANNUAL SUPPLY / DEMAND

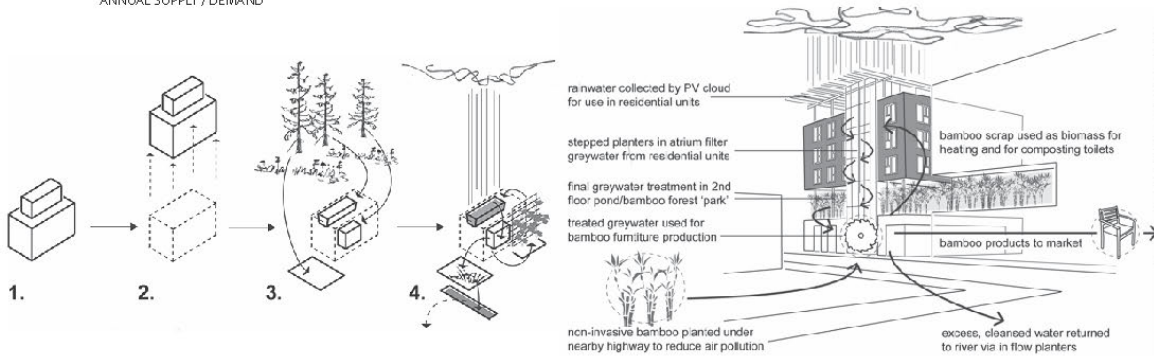
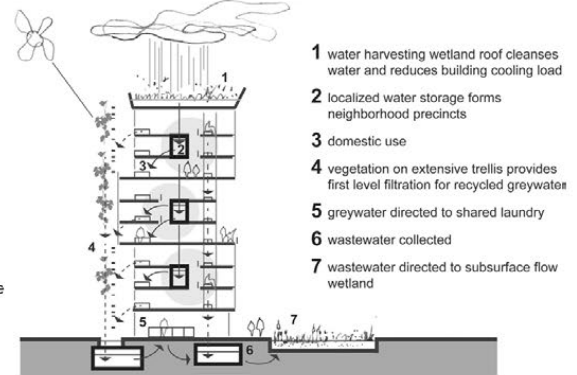
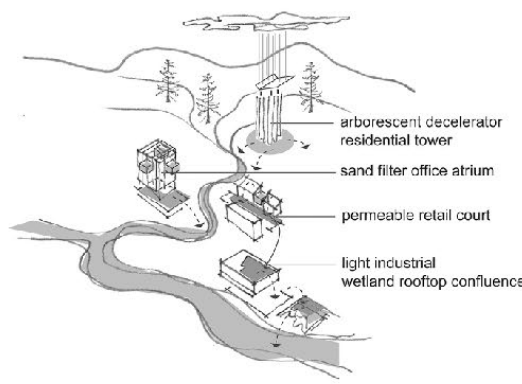

Kevin Nute

Two new book contracts with Routledge:

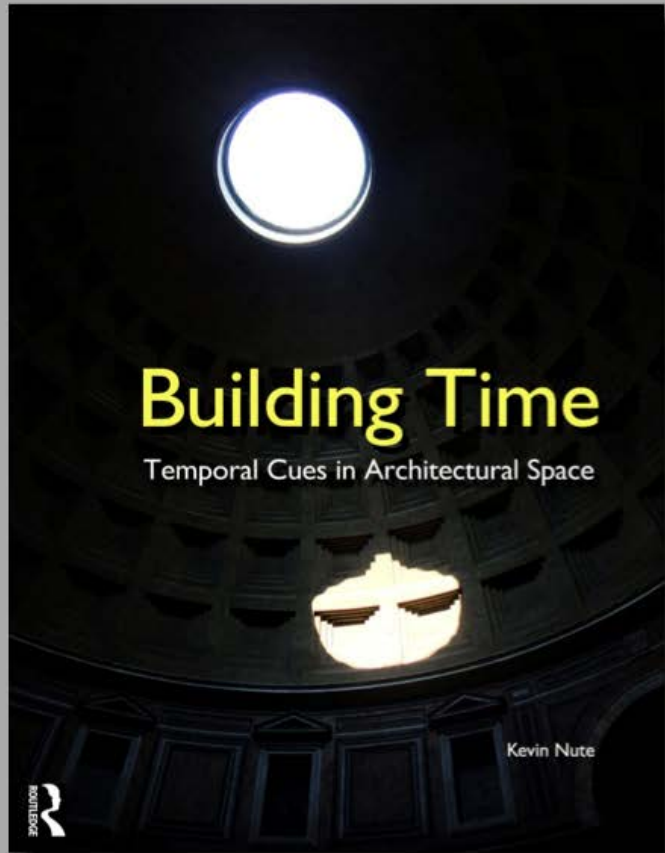

Building Time explains how built environments can be designed to support positive recollections of the past, interactions with the present, and anticipations of the future.

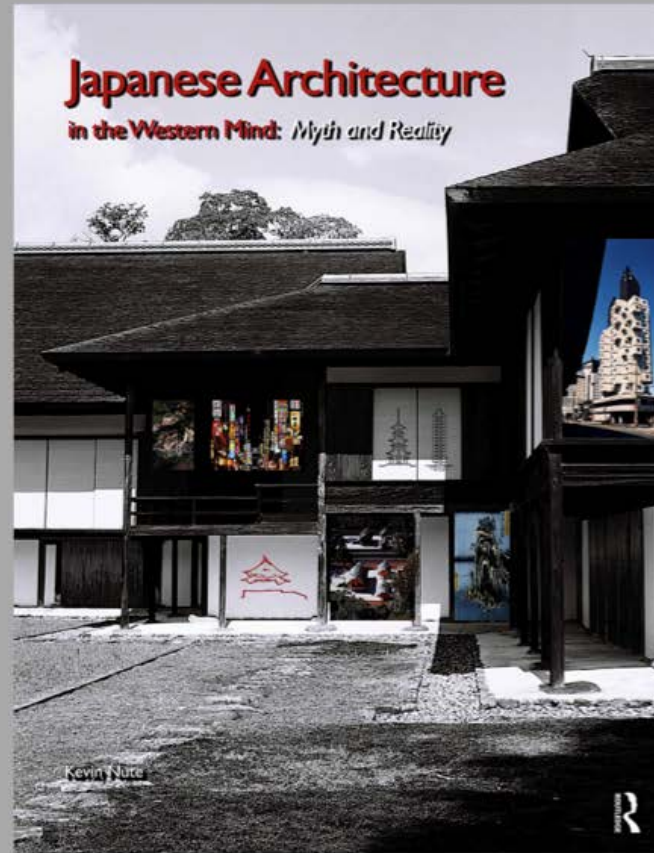

Japanese Architecture in the Western Mind shows how early Western preconceptions of Japan created what amounted to a mythical Japanese architecture in the West which still informs perceptions of contemporary Japanese architecture to this day

Judith Sheine

Bunkhouse for Camp Talaoli, which will demonstrate the new Mass Plywood Panels being produced by Freres Lumber. Professor Judith Sheine and Associate Professor Mark Donofrio, with students David Moreno, Konrad Stuebgen and Jennah Byrd, are designing this project in association with the TallWood Design Institute.





Atmosphere Informed: Emerging data collection tools allow us to rethink site observation for design. We can acquire new knowledge about place by measuring atmospheric phenomena and sensing small-scale differences across multiple time scales.

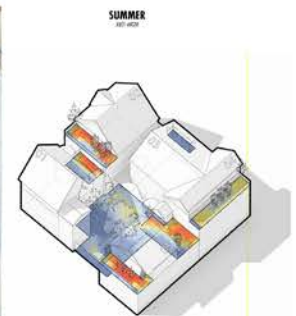
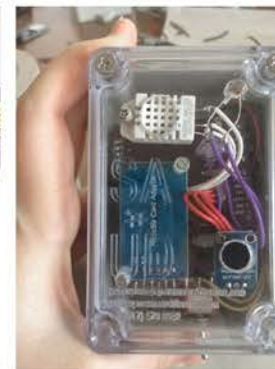
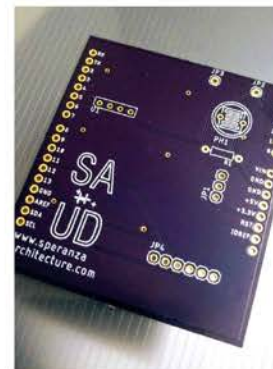

current research and practice

PUARL 10 Year Anniversary Conference

MIGRATION, REFUGEES, AND PATTERNS



<http://puarl.uoregon.edu/>

Christopher Alexander Lecture by David Seamon: "Ways of Understanding Wholeness: Christopher Alexander's work as synergistic relationality."

PUARL Lecture by Wayne Cornelius: "Constructing Deterrence in Immigration and Refugee Policy: The Case of Mexican and Central American Migrants and Asylum-seekers."

After the successful completion of the PUARL Regenerative City 2016 International Conference in San Francisco and the latest associated PURPLSOC World Conference in Austria, Europe in the Fall of 2017, we are in the process of preparing the 10 Year Anniversary PUARL Conference for Fall 2018 in Portland, Oregon. The 2018 PUARL Conference will be held in conjunction with the Pattern Languages of Programs (PLoP) conference on October 24th and 25th. October 26th will focus on investigating the future of pattern language and the expanded pattern language approach and its innovations. Saturday, October 27th and Sunday, October 28th are dedicated to the increasingly globally critical topics of "Migration, Refugees, and Patterns."

Future of Pattern Language

For this particular day we are asking the questions: What is the future of pattern language in its various fields and what is its future altogether? For architecture, we can ask what is the future of the overall or expanded pattern language approach that includes many more principles and modes of operation than the traditional pattern language. As an overarching question for many of the disciplines that participate in these conferences, we can paraphrase Wolfgang Stark's question: "Now we all know that we are working with a form of a pattern language method, but what are we working on all together that makes our work interdisciplinary and possibly a network of patterns of different disciplines?" We will examine the possibility of working on larger issues with the pattern language method.

Migration, Refugees, and Patterns

PUARL has embarked on an initiative to research and address the growing problems of global forced displacement, migration, and refugees, as well as integration in host countries and communities. We invite academics, practitioners, activists, and people who have experienced displacement to join us in addressing the critical issues of global forced migration. This conference will emphasize the spatial aspects of displacement at multiple scales, from neighborhood to international, and the ways in which forced migration is experienced differently spatially for different demographics and in different political regimes. We pay special attention to the situations in North and South America and Europe, although proposals related to all regions are welcomed. Sub-themes of particular interest include: homelessness and refugees, climate change migration, and Indigenous peoples and displacement, particularly in the North American context.

10/26 Friday: Future of Pattern Language

9:00 - 9:30AM	Opening and Welcome
9:30 - 11:00AM	Plenary Session
11:00 - 12:00PM	Session Session Session
12:00 - 1:00PM	Break
1:00 - 2:30 PM	Plenary Session
2:30 - 3:30 PM	Session Session Session
3:30 - 4:30 PM	Session Session Session
4:30 - 6:00 PM	Celebration Keynote: D. Seamon
6:00 - 8:00 PM	Welcome Reception

10/27 Saturday: Migration, Refugees, and Patterns

9:00 - 9:30AM	Opening Session
9:30 - 11:00AM	Plenary Session
11:00 - 12:00PM	Session Session Session
12:00 - 1:00PM	Break
1:00 - 2:30 PM	Plenary Session PUARL Lecture
2:30 - 3:30 PM	Session Session Session
3:30 - 4:30 PM	Session Session Session
4:30 - 6:00 PM	Plenary Session
6:00 - 8:00 PM	Dinner

10/28 Sunday: Migration, Refugees, and Patterns

9:00 - 10:30AM	Plenary Session
10:30 - 11:30PM	Session Session Session
11:30 - 12:30 PM	Break
12:30 - 2:00 PM	Plenary Session, Panel Discussion
2:00 - 2:30 PM	Closing

CALL FOR PARTICIPATION, PAPERS, AND CONTRIBUTIONS

The organizers encourage proposals for a variety of session types, particularly interactive sessions. Details are included on the conference website: <https://blogs.uoregon.edu/puarl2018>. Please send abstracts and proposals to puarl@uoregon.edu by June 30th. Proposals will be peer-reviewed by the Program and Academic International Committee and acceptance will be announced by July 31st. Accepted, full papers can be submitted to PUARL by September 15, 2018 for inclusion in a conference record in 2018. Registration will open June 15th. Full conference early bird registration fee is \$400 (until September 1st), not including the 10 Year Anniversary Publication or the Saturday dinner. Presenters will be expected to pay the full conference fee and to fund their travel expenses.

Proposals Due: June 30, 2018.
Acceptance Announcements: July 31, 2018
Registration Opens: June 15, 2018
Full Papers Due: September 15, 2018
PLoP Conference October 24-26
PUARL Conference October 26-28, 2018
October 26: Joint keynote with PUARL and PLoP
More details on website: <https://blogs.uoregon.edu/puarl2018>

WHY DID YOU JOIN
THE FACULTY HERE?

A decorative graphic consisting of several parallel white lines of varying lengths, slanted diagonally from the bottom-left towards the top-right, located in the lower right quadrant of the slide.

WHAT MAKES YOU
COMMITTED TO THIS
PLACE?



HOW CAN WE
SUPPORT YOU BETTER?

A series of several parallel white lines of varying lengths, all slanted upwards from left to right, positioned in the lower right quadrant of the image.

WHAT ARE YOU MOST
CONCERNED ABOUT?

A decorative graphic consisting of several parallel white lines of varying thicknesses, slanted diagonally from the bottom right towards the top right, set against a blue gradient background.