

CURR. HIST. STATUS:

RANKING: Primary
NEIGHBORHOOD: DNTN
TYPE: Building

OREGON CULTURAL RESOURCE INVENTORY
CITY OF EUGENE

FINAN. STATUS:

HISTORIC NAME: MINER BUILDING DATE OF CONSTRUCTION: 1924
COMMON NAME: EUGENE PROFESSIONAL BLDG. ORIGINAL USE: Office
ADDRESS: 0132 E BROADWAY PRESENT USE: Office
EARLY AD: 132 E BROADWAY DATE: S 1925
OWNER: Jimmy R. Causby ARCH./BLDR.: Hunziker
ADDR: 132 E. Broadway ARCH./STYLE: Half Modern
 Eugene, OR 97401 000
T/R/S# 17 3 31 NE 1/4 SE 1/4 INTEGRITY: Minor Modifications
MAP NO.: 17033114 TAXLOT: 6600 THEME: 13 000
ADD: Mulligans BLK: 13 LOT: 2&3
ZONING: Central Business Dist. PROP. GROUP: / /
PLAN SHAPE: rect #STORIES: 8.0 BASEMENT (Y/N/?):
FOUNDATION MATERIAL: reinforced conc.
ROOF FORM & MATERIALS: flat
WALL CONSTRUCTION: reinforced conc. STRUCTURAL FRAME: ??
PRIMARY WINDOW TYPE: plate gl. w/transom mtl. casement
EXT. SURFACING MATERIALS: stucco
DECORATIVE FEATURES: pilasters @ ends & center parapet w/projecting
OTHER: cornice.
CONDITION: Good MOVED: N DATE MOVED:

EXT. ALTERATIONS/ADDITIONS(DATED): modern. awning ,sign, & storefront winds.
and dr., adjacent bldg. (to W.) may be addition

NOTEWORTHY LANDSCAPE FEATURES:
??

ASSOCIATED STRUCTURES:

KNOWN ARCHAEOLOGICAL FEATURES: street has medianw/trees

GEOG. LOC. & IMMED. SETTING: mid-blk; flat; commercial-dense; flat and
S. of park blks. E. and S. walls border alleys.

PHYSICAL DESCRIPTION: This 8 story Half Modern building is located mid-
block in a commercial area, on the east side of downtown. The building is
in good condition and has had minor modifications. The building has a
rectangular plan with a reinforced concrete foundation and walls. The roof
is flat, while the primary window type is plate glass with a transcom and
metal casement. The exterior surface is stucco. Additional decorative
features include: beltcourse running across front matching stringcourse on
adjacent frieze with narrow vertical panels, windows faced with gram marble
recessed entry decorative tile.

SOURCES: Sanborn Insurance Maps 1884-1948, Cascade Title Company, Polks &
Obenauer City Directories, Lane County Historical Museum Photo Collection.

ROLL NO.: 21
NEGATIVE NO.: 010
SLIDE ROLL#: 010
SLIDE NO.: 000005

RECORDED BY: N. Stricker
RESEARCHED BY: Liz Carter
DATE RECORDED: 05/13/1989
FIELD INVENTORY NO.: 00000
STATE INVENTORY NO.: 2338

SHPO 2337

OREGON CULTURAL RESOURCE INVENTORY
CITY OF EUGENE

HISTORIC NAME: THE MINER BUILDING T/R/S#: 17 3 31 NE 1/4 SE 1/4
ADDRESS: 132 E. BROADWAY TAXLOT: 6600

STATEMENT OF SIGNIFICANCE

Eugene Professional Building-Miner Building
132 East Broadway

The Miner Building is one of the most visible examples of early twentieth-century commercial architecture in Eugene. Built by W. E. Miner in 1924, it was the first true high-rise office building in the city. Its dimensions, design, and detailing express a "modern" idea of professionalism which crystallized in the 1920's. The emergence of this perception of the role of the professional was connected to the growth of a substantial urban professional class supported by the rapid economic expansion of the 1920's and the accompanying growth in population. The primary occupants of the Miner Building have been representatives of this class, doctors, lawyers, etc., since its construction. The first and second floors have housed commercial uses throughout that time. During the 1920's, these included Applegate's Furniture Company, Crown Drugs, Lucille's Tea Room, the Eugene Business College, and Pacific Telephone and Telegraph Company.

The Miner Building, the Eugene Hotel, the Quackenbush Building, and Lee-World Travel create a gateway of historic commercial buildings to Eugene's business district. This ensemble portrays a city, rather than a town, and signifies the evolution of Eugene's downtown to a twentieth-century urban landscape.

The Miner building expresses a strong relationship with a broad pattern of history of the nation and community, and embodies the distinctive characteristics of a type, period, and method of construction. Although there have been changes in fenestration and entry detail, the overall integrity of the building is high. The Miner Building is the work of architect John Hunzicker, a designer whose work has influenced development in the community and state. The Miner Building should be treated as eligible for the National Register of Historic Sites and Places and of primary significance.

FIELD SURVEY NO: 00000
STATE INVENTORY NO: 0

OREGON CULTURAL RESOURCE INVENTORY
CITY OF EUGENE

HISTORIC NAME:
ADDRESS: 0132 E BROADWAY

T/R/S# 17 3 31 NE 1/4 SE 1/4
TAXLOT: 6600



ROLL NO: 21
NEGATIVE NO.: 010

SLIDE ROLL NO: 010
SLIDE NO. 000005

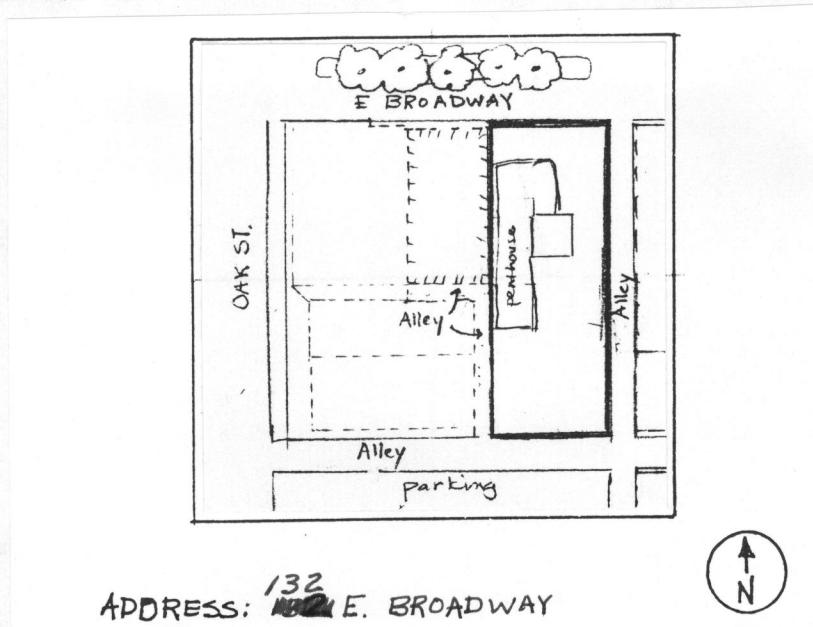

SITE PLAN DRAWN BY:
GRAPHIC & PHOTO SOURCES:

FIELD SURVEY NO: 00000
STATE INVENTORY NO: 0

DOWNTOWN CULTURAL RESOURCES SURVEY AND INVENTORY EVALUATION CRITERIA, 1991

ADDRESS: 132 E Broadway INVENTORY NUMBER: _____
 MAP/TAX LOT #: _____ TOTAL SCORE: 11 FINAL RANKING: P S C NC

Please rank properties using a numerical ranking of 0-5. 0 = Does not meet criteria; 1 = Low merit under this criteria; 2 = Some merit under this criteria; 3 = Average merit under this criteria; 4 = Strong merit under this criteria; 5 = Very Strong merit under this criteria.

CRITERIA	RANKING
1. Association with historic or famous events.	<u> </u>
2. Antiquity.	<u> 1 </u>
3. Unique architectural merit because: (There are only a total of 5 points allowed for all parts of #3.)	<u> 5 </u>
a. Representative character of a period or style of architecture or method of construction;	<u> 4 </u>
b. Extraordinary or unusual design, detail, use of materials or craftsmanship;	<u> 3 </u>
c. Identification as the work of an architect, designer, or master builder whose individual work has influenced development in the nation, state, or community.	<u> </u>
4. Relationship to the broad cultural history of the nation, state or community.	<u> 5 </u>
5. Identification with a person or persons who have significantly contributed to the history of the nation, state, or community.	<u> </u>
6. Identification as a unique object representing an aesthetic or educational feature of the community.	<u> </u>

LEVEL OF INTEGRITY: Med - High
 LANDMARK STATUS: _____

Evaluator *[Signature]* Date 8/8/71